

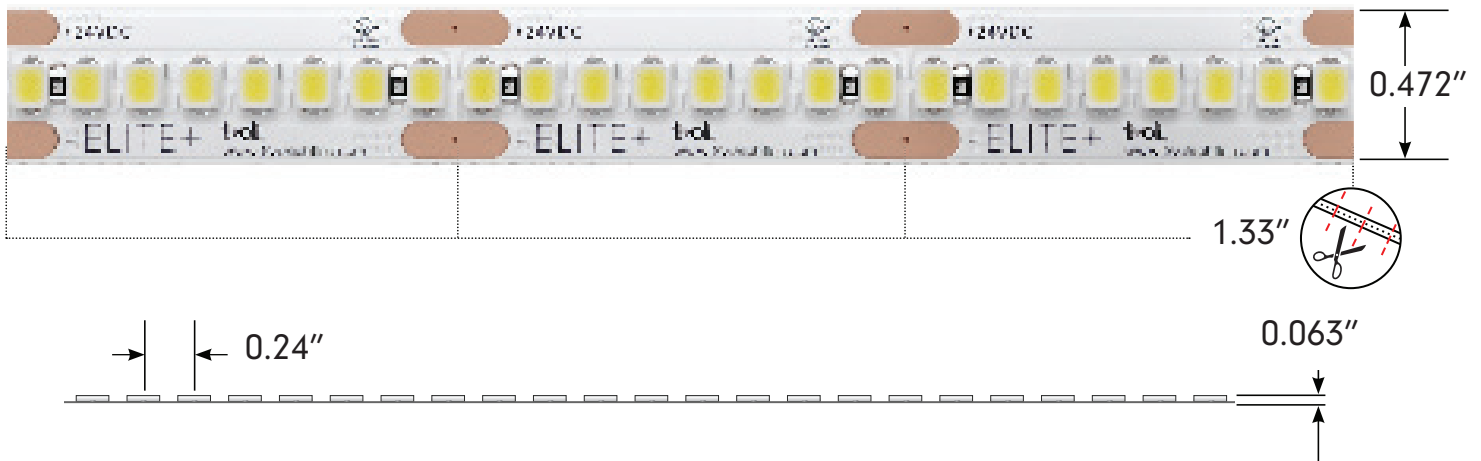

Project: _____ TYPE: _____

- Multiple intensities to choose from
- Low bin tolerance with a 1.5 Step McAdam Elipse standard
- High efficacy value
- Includes Tivoli's eXo shield coating
- Factory soldered lead wire
- Standard IP54 damp rated and IP67 wet location available
- Multiple mounting channel options
- Large range of available Kelvin temperatures
- Low lead times
- 4oz. Copper Trace
- 5 Year warranty

Dimensions





Order Guide

| PRODUCT CODE | INTENSITY | INSTALL | LED COLOR | VOLTAGE |
|-------------------------------------|--|-------------------|--|--------------------|
| TPLEP | | I | | 24 |
| TPLEP = TivoTape ELITE Plus+ | XLB = Extra Low Brightness LB = Low Brightness SB = Standard Brightness HO = High Output VHO = Very High Output UHO = Ultra High Output | I = Indoor | 18 = 1800K 22 = 2200K 24 = 2400K 27 = 2700K 30 = 3000K 35 = 3500K 40 = 4000K 50 = 5000K | 24 = 24V DC |

Note: A layout/drawing must accompany each order showing run length and location
 Note: Runs with LEAD-C are rounded **up** to next cut interval (unless otherwise specified)
 Note: Runs with LEAD-D are rounded **down** to next cur interval (unless otherwise specified)

Specification

| XLB Low Brightness | | | | | | | | | LB Low Brightness | | | | | | | | |
|---------------------|-------|-------|-------|-------|-------|-------|-------|-------|---------------------|-------|-------|-------|-------|-------|-------|-------|-------|
| Kelvin Temperature | 1800K | 2200K | 2400K | 2700K | 3000K | 3500K | 4000K | 5000K | Kelvin Temperature | 1800K | 2200K | 2400K | 2700K | 3000K | 3500K | 4000K | 5000K |
| Lumens/ft | 51 | 65 | 65 | 79 | 83 | 78 | 92 | 82.8 | Lumens/ft | 178 | 168 | 169 | 204 | 220 | 202 | 242 | 203 |
| Efficacy (Lm/W) | 102 | 129 | 130 | 157 | 164 | 155 | 182 | 164 | Efficacy (Lm/W) | 123 | 120 | 121 | 146 | 152 | 144 | 171 | 145 |
| CRI | 93.5 | 93.5 | 93.5 | 93.5 | 93.5 | 94 | 93.7 | 93.5 | CRI | 93.2 | 93 | 94 | 94 | 92.9 | 93 | 93.6 | 94 |
| Measured Power W/ft | 0.5 | 0.5 | 0.5 | 0.5 | 0.5 | 0.5 | 0.5 | 0.5 | Measured Power W/ft | 1.4 | 1.4 | 1.4 | 1.4 | 1.4 | 1.4 | 1.4 | 1.4 |
| Listed Power W/ft. | 0.6 | | | | | | | | Listed Power W/ft. | 1.5 | | | | | | | |
| Max Run | 150' | | | | | | | | Max Run | 60' | | | | | | | |

| SB Standard Brightness | | | | | | | | | HO High Output | | | | | | | | |
|------------------------|-------|-------|-------|-------|-------|-------|-------|-------|---------------------|-------|-------|-------|-------|-------|-------|-------|-------|
| Kelvin Temperature | 1800K | 2200K | 2400K | 2700K | 3000K | 3500K | 4000K | 5000K | Kelvin Temperature | 1800K | 2200K | 2400K | 2700K | 3000K | 3500K | 4000K | 5000K |
| Lumens/ft | 324 | 405 | 408 | 491.8 | 509 | 491 | 502 | 492 | Lumens/ft | 462 | 578 | 590 | 701 | 724 | 688 | 714 | 697 |
| Efficacy (Lm/W) | 106 | 135 | 136 | 164 | 171 | 195 | 167 | 163 | Efficacy (Lm/W) | 106 | 135 | 137 | 163 | 170 | 161 | 166 | 162 |
| CRI | 93.2 | 92.6 | 93.2 | 92.7 | 93.4 | 94 | 93.4 | 94.1 | CRI | 93 | 93 | 93 | 93 | 93 | 92 | 93 | 94 |
| Measured Power W/ft | 3.0 | 3.0 | 3.0 | 3.0 | 2.97 | 2.5 | 3.0 | 3.0 | Measured Power W/ft | 4.3 | 4.3 | 4.3 | 4.25 | 4.26 | 4.3 | 4.3 | 4.3 |
| Listed Power W/ft. | 3.2 | | | | | | | | Listed Power W/ft. | 4.5 | | | | | | | |
| Max Run | 29' | | | | | | | | Max Run | 20' | | | | | | | |

| VHO Very High Output | | | | | | | | | UHO Ultra High Output | | | | | | | | |
|----------------------|-------|-------|-------|-------|-------|-------|-------|-------|-----------------------|-------|-------|-------|-------|-------|-------|-------|-------|
| Kelvin Temperature | 1800K | 2200K | 2400K | 2700K | 3000K | 3500K | 4000K | 5000K | Kelvin Temperature | 1800K | 2200K | 2400K | 2700K | 3000K | 3500K | 4000K | 5000K |
| Lumens/ft | 626 | 806 | 812 | 979 | 1023 | 967 | 1006 | 974 | Lumens/ft | 759 | 932 | 973 | 1132 | 1230 | 1224 | 1340 | 1167 |
| Efficacy (Lm/W) | 103 | 133 | 134 | 161 | 168 | 159 | 166 | 160 | Efficacy (Lm/W) | 89 | 114 | 115 | 138 | 144 | 144 | 164 | 137 |
| CRI | 93 | 93 | 93 | 93 | 93.2 | 93 | 93.1 | 93 | CRI | 93 | 93 | 93 | 93 | 93 | 93 | 93 | 93 |
| Measured Power W/ft | 6.08 | 6.08 | 6.08 | 6.08 | 6.08 | 6.08 | 6.1 | 6.08 | Measured Power W/ft | 8.5 | 8.2 | 8.5 | 8.2 | 8.5 | 8.5 | 8.2 | 8.5 |
| Listed Power W/ft. | 7 | | | | | | | | Listed Power W/ft. | 9 | | | | | | | |
| Max Run | 13' | | | | | | | | Max Run | 10' | | | | | | | |

Specification

| Electrical | |
|---------------------------|--|
| Input Voltage | 24V |
| Dimming | MLV/ELV/0-10V/DMX |
| Physical | |
| LED Package | 2835 |
| LEDs/ft | 73 |
| Adhesive | 3M VHB Tape |
| Copper Trace | 4 Ounce |
| Dimensions | 0.472" (12mm) |
| Cut Increments | 1.33" (34mm) |
| Operating Temperature | -40°F (-40°C) ~ +140°F (+60°C) |
| Certification and Testing | |
| Certification | UL Listed, CE |
| Lumen Maintenance (L70) | 60,000 hrs |
| Binning Tolerance | 1.5 Step MacAdam Elipse |
| Environment | IP54 Damp Location, Conformal eXo Shield |
| Warranty | 5 years |

Photometrics

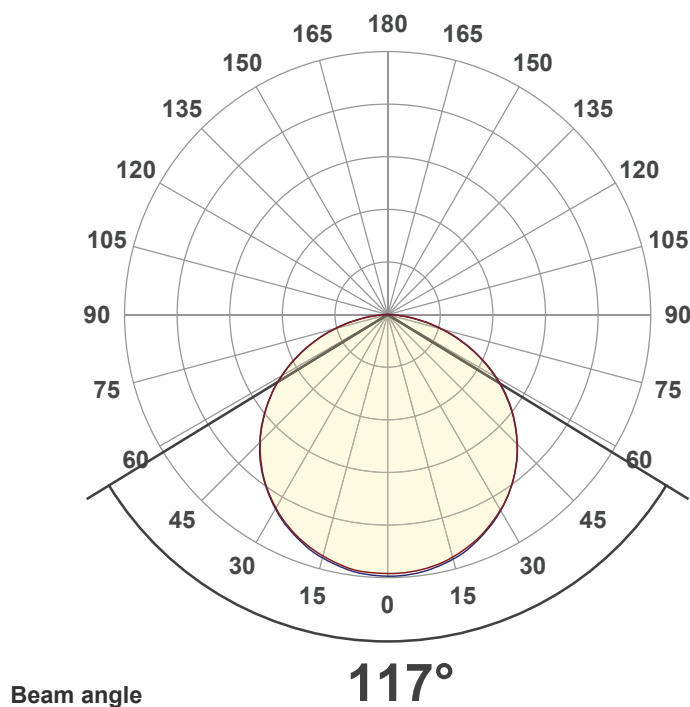

Power Leads and Jumpers (Installed by Tivoli's certified solderers)



TPL-I-LEAD-2-C
LEAD/END
24" standard 2 conductor
18AWG lead wire factory
attached to one end of tape



TPL-I-LEAD-2-D
LEAD/LEAD
24" standard 2 conductor
18AWG lead wire factory
attached to both ends of tape

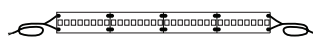

TPL-I-XEP-2
EXTRA LEAD WIRE
Additional factory attached
18AWG lead 2 wire to extend
lengths of LEAD-C and LEAD-D
up to 20 ft. max
Sold per foot

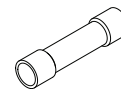

TPL-I-CONN
18-22AWG BUTT CONNECTORS
Used to interconnect factory
attached lead wires.
Sold individually.

Compatible Extrusions

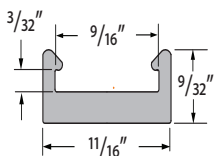

MCHAN-8-LP
Low profile NO LENS OPTION
clear polycarbonate, length 8'

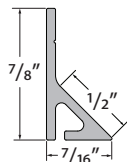

TPL-I-45-MCH-8-S
White PVC, 45° NO LENS
length 8'

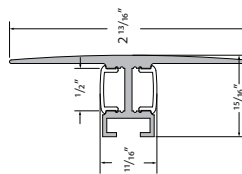

DWAR-CHAN-SLV-6.5
Anodized Aluminum Extrusion,
available in 6.5' lengths

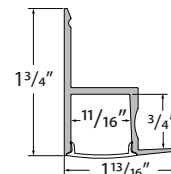

EDGE-CHAN-SLV-6.5
Anodized Aluminum Extrusion,
available in 6.5' lengths

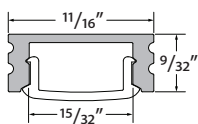

MINI-CHAN-SLV-6.5
Anodized Aluminum Extrusion,
available in 6.5' lengths

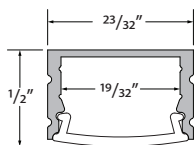

MOFT-CHAN-SLV-6.5
Anodized Aluminum Extrusion,
available in 6.5' lengths

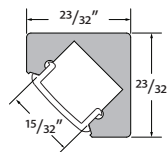

DYER-CHAN-SLV-6.5
Anodized Aluminum Extrusion,
available in 6.5' lengths

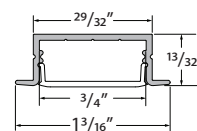

WRNR-CHAN-SLV-6.5
Anodized Aluminum Extrusion,
available in 6.5' lengths

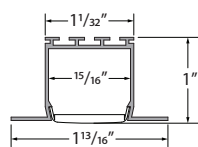

NOYS-CHAN-SLV-6.5
Anodized Aluminum Extrusion,
available in 6.5' lengths

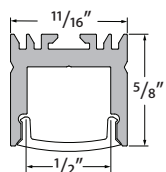

VALN-CHAN-SLV-6.5
Anodized Aluminum Extrusion,
available in 6.5' lengths

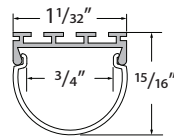

DOM-CHAN-SLV-6.5
Anodized Aluminum Extrusion,
available in 6.5' lengths

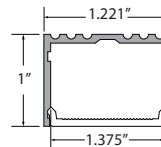

ALTN-CHAN-SLV-6.5
Anodized Aluminum Extrusion,
available in 6.5' lengths

Compatible Extrusions

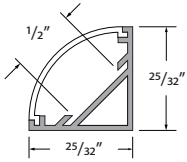

MRSL-CHAN-SLV-6.5
Anodized aluminum extrusion available in 6.5' length

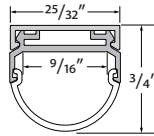

HRIZ-CHAN-SLV-6.5
Anodized aluminum extrusion available in 6.5' length

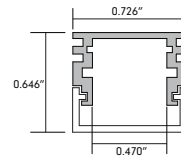

ASTR-CHAN-SLV-6.5
Anodized aluminum extrusion available in 6.5' length

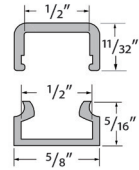

INF-X-CHAN-8
X = C (clear), **F** (frosted)
PC extrusion, available in 8' lengths

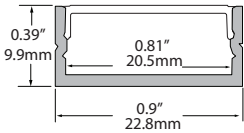

COTA-CHAN-SLV-6.5
Anodized Aluminum Extrusion, available in 6.5' lengths

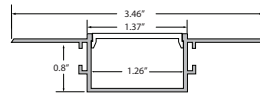

CARU-CHAN-SLV-6.5
Anodized aluminum extrusion, available in 6.5' lengths

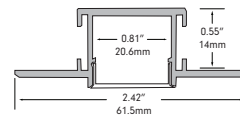

HAYS-CHAN-SLV-6.5
Anodized Aluminum Extrusion, available in 6.5' lengths

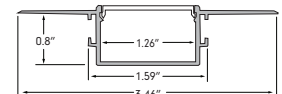

GLOR-CHAN-XXX-6.5
Anodized Aluminum Bendable Extrusion, available in 6.5' lengths

In-Wall Controls



Touchscreen

TVOQ-1-WH
White



Touchscreen

TVOQ-10-XX-7
XX = BK (Black), **WH** (White)



Touchscreen

TVOQ-2-BK
Black

Recommended Power Supplies

INFINITY - MLV / ELV / 0-10V / PWM / TRIAC

| DESCRIPTION | CAT NO | APPLICATION | PRIMARY VOLTAGE | SECONDARY VOLTAGE | CIRCUIT BREAKERS | MAX LOAD | MIN LOAD | CIRCUIT CAPACITY |
|--|-------------------|---------------------|-----------------|-------------------|------------------|----------|----------|------------------|
| Infinity Series Class 2 Transformer | INF-J-30-1-1.3-24 | Indoor / Outdoor | 100 - 277V AC | 24V DC | 1 | 30W | 3W | 1.3A |
| | INF-J-60-1-2.5-24 | | | | 1 | 60W | 6W | 2.5A |
| | INF-J-96-1-4-24 | | | | 1 | 96W | 9W | 4A |
| | INF-J-192-2-4-24 | | | | 2 | 2x96W | 2x9W | 2x4A |
| | INF-J-288-3-4-24 | | | | 3 | 3x96W | 3X9W | 3x4A |

ER

| DESCRIPTION | CAT NO | APPLICATION | PRIMARY VOLTAGE | SECONDARY VOLTAGE | CIRCUIT BREAKERS | MAX LOAD | CIRCUIT CAPACITY |
|---------------------------------|-------------------|---------------------|-------------------------|-------------------|------------------|----------|------------------|
| ER Series Class 2 | ER-80-1-3-3-24-D | Indoor / Outdoor | 100-277V AC 50/60 Hz | 24V DC | 1 | 80W | 3.3A |
| ER Series Class 2 0-10V Dimming | ERG-80-24-DIM1-10 | | | | | | |

ADUL/ADNM - NON DIMMING

| DESCRIPTION | CAT NO | APPLICATION | PRIMARY VOLTAGE | SECONDARY VOLTAGE | CIRCUIT BREAKERS | MAX LOAD | CIRCUIT CAPACITY |
|---|-------------------|---------------------|-------------------------|-------------------|------------------|----------|------------------|
| ADUL/ADNM Series Class 2 Transformer | ADNM-90-1-4-24-D | Indoor / Outdoor | 100-277V AC 50/60 HZ | 24V DC | 1 | 90W | 3.75A |
| | ADUL-120-1-4-24-D | | | | 1 | 96W | 4A |
| | ADUL-240-2-4-24-D | | | | 2 | 2x96W | 2x4A |
| | ADUL-320-3-4-24-D | | | | 3 | 3x96W | 3x4A |

ADUL/ADNM - 0-10V DIMMING

| DESCRIPTION | CAT NO | APPLICATION | PRIMARY VOLTAGE | SECONDARY VOLTAGE | CIRCUIT BREAKERS | MAX LOAD | CIRCUIT CAPACITY |
|---|---------------------|---------------------|-------------------------|-------------------|------------------|----------|------------------|
| ADUL/ADNM Series Class 2 Transformer | ADNM-90-1-4-24-DOT | Indoor / Outdoor | 100-277V AC 50/60 HZ | 24V DC | 1 | 90W | 3.75A |
| | ADUL-120-1-4-24-DOT | | | | 1 | 96W | 4A |
| | ADUL-240-2-4-24-DOT | | | | 2 | 2x96W | 2x4A |
| | ADUL-320-3-4-24-DOT | | | | 3 | 3x96W | 3x4A |

ADUL/ADNM - DMX SINGLE ADDRESS

| DESCRIPTION | CAT NO | APPLICATION | PRIMARY VOLTAGE | SECONDARY VOLTAGE | CIRCUIT BREAKERS | MAX LOAD | CIRCUIT CAPACITY |
|---|---------------------|---------------------|-------------------------|-------------------|------------------|----------|------------------|
| ADUL/ADNM Series Class 2 Transformer | ADNM-90-1-4-24-DIN | Indoor / Outdoor | 100-277V AC 50/60 Hz | 24V DC | 1 | 90W | 3.75A |
| | ADUL-120-1-4-24-DIN | | | | 1 | 96W | 4A |
| | ADUL-240-2-4-24-DIN | | | | 2 | 2x96W | 2x4A |
| | ADUL-320-3-4-24-DIN | | | | 3 | 3x96W | 3x4A |

Recommended Power Supplies

ADUL - DMX MULTI ADDRESS

| DESCRIPTION | CAT NO | APPLICATION | PRIMARY VOLTAGE | SECONDARY VOLTAGE | CIRCUIT BREAKERS | MAX LOAD | CIRCUIT CAPACITY |
|------------------------------------|-----------------------|---------------------|-------------------------|-------------------|------------------|----------|------------------|
| ADUL Series Class 2 Transformer | ADUL-240-2-4-24-DIN-2 | Indoor / Outdoor | 100-277V AC 50/60 Hz | 24V DC | 2 | 2x96W | 2x4A |
| | ADUL-320-3-4-24-DIN-3 | | | | 3 | 3x96W | 3x4A |

ADNM - DMX/DALI FLICKER-FREE FOR TV STUDIO

| DESCRIPTION | CAT NO | APPLICATION | PRIMARY VOLTAGE | SECONDARY VOLTAGE | CIRCUIT BREAKERS | MAX LOAD | CIRCUIT CAPACITY |
|------------------------------------|---------------------|---------------------|-------------------------|-------------------|------------------|----------|------------------|
| ADNM Series Class 2 Transformer | ADNM-120-1-4-24-DTV | Indoor / Outdoor | 100-277V AC 50/60 HZ | 24V DC | 1 | 1x96W | 1x4A |
| | ADNM-240-2-4-24-DTV | | | | 2 | 2x96W | 2x4A |
| | ADNM-320-3-4-24-DTV | | | | 3 | 3x96W | 3x4A |

Recommended Dimmers

DIMMING - 0-10V

| DESCRIPTION | CAT NO | APPLICATION | INPUT VOLTAGE | OUTPUT VOLTAGE | MAX LOAD |
|--------------|------------|-------------|---------------|----------------|----------------------------------|
| 0-10V Dimmer | DIM-LD-010 | Indoor | 12V/24V DC | 12V/24V DC | 30 mA max. output (sink only) |

DIMMING -MLV

| DESCRIPTION | CAT NO | APPLICATION | INPUT VOLTAGE | OUTPUT VOLTAGE | MAX LOAD |
|-------------|--------|-------------|---------------|----------------|----------|
| MLV Dimmer | N-600 | Indoor | 120V AC | 120V AC | 450W |
| | N-1000 | | | | 800W |
| | N-1500 | | | | 1200W |
| | D-600 | | | | 450W |
| | M-600 | | | | 450W |
| | M-1000 | | | | 800W |

DIMMING - ELV

| DESCRIPTION | CAT NO | APPLICATION | INPUT VOLTAGE | OUTPUT VOLTAGE | MAX LOAD |
|-------------|--------|-------------|---------------|----------------|----------|
| ELV Dimmer | ME-600 | Indoor | 120V AC | 120V AC | 450W |
| | DE-300 | | | | 300W |